

TR Hank® Rivet Bushes

Serrated Face Mini Standoff (MF)

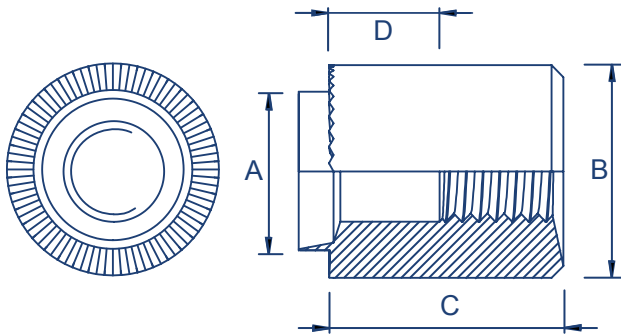

Steel/Zinc & Clear (TC1) | Steel/Self Finish (SF) | Stainless Steel/Self Finish (SF)



Metric Dimensions

| Thread form | | M2.5 | M3 | M3.5 | M4 | M5 | M6 | M8 | M10 | M12 |
|-------------------------------------|---|--------------------------|------|-----------|------|-----------|-------|------------|-------|-------|
| Diameter of spigot +0.00 -0.13mm | A | 4.19 | 4.19 | 5.41 | 5.41 | 6.40 | 7.70 | 9.70 | 12.70 | 15.87 |
| Diameter of body ±0.15mm | B | 5.50 | 5.50 | 7.00 | 7.00 | 8.50 | 10.00 | 12.00 | 16.00 | 19.00 |
| Recommended hole size +0.05 -0.00mm | | 4.19 | 4.19 | 5.41 | 5.41 | 6.40 | 7.70 | 9.70 | 12.70 | 15.87 |
| Length of body ±0.13mm | C | To customer requirements | | | | | | | | |
| Length of body ±0.13mm | C | 8-10mm | | 11-13mm | | 14-16mm | | 14-22mm | | |
| Depth of c/bore | D | 3.0mm Nom | | 6.0mm Nom | | 9.0mm Nom | | 12.0mm Nom | | |

Imperial/Unified Dimensions

| Thread form | BSW/F | - | 1/8" | - | 5/32" | 3/16" | 1/4" | 5/16" | 3/8" | 1/2" |
|-------------------------------------|-------|--------------------------|------|-----------|-------|-----------|------|------------|------|------|
| | BA | - | 6 | 4 | 3 | 2 | 0 | - | - | - |
| | UNC | - | 4 | 6 | 8 | 10 | 1/4" | 5/16" | 3/8" | 1/2" |
| | UNF | - | 4 | 6 | 8 | 10 | 1/4" | 5/16" | 3/8" | 1/2" |
| Diameter of spigot +0.000 -0.005 | A | .165 | .165 | .213 | .213 | .252 | .303 | .382 | .500 | .625 |
| Diameter of body +0.010 | B | .217 | .217 | .276 | .276 | .335 | .394 | .472 | .625 | .750 |
| Recommended hole size +0.05 -0.00mm | | .165 | .165 | .213 | .213 | .252 | .303 | .382 | .500 | .625 |
| Length of body ±0.005" | C | To customer requirements | | | | | | | | |
| Length of body ±0.005" | C | 8-10mm | | 11-13mm | | 14-16mm | | 14-22mm | | |
| Depth of c/bore | D | 3.0mm Nom | | 6.0mm Nom | | 9.0mm Nom | | 12.0mm Nom | | |

All Imperial/Unified sizes are non-preferred - please enquire for availability